

**PRESENTATION – PRÉSENTATION – ANSICHT**

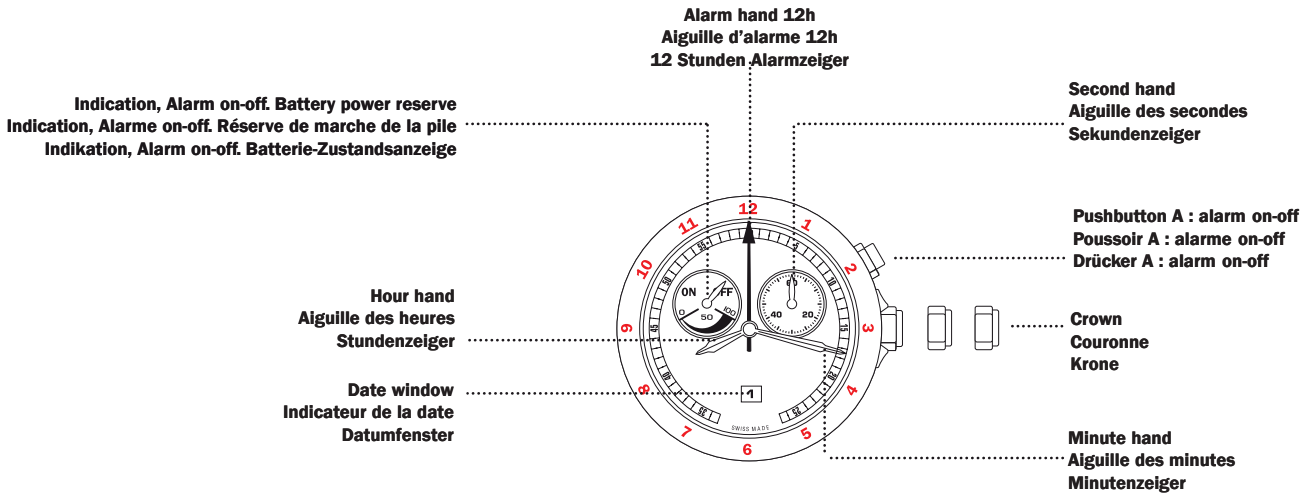

**SETTING THE TIME  
HOUR AND MINUTE**

**REGLAGE DE L'HEURE  
ET MINUTE**

**EINSTELLEN DER ZEITANZEIGE  
STUNDEN UND MINUTEN**

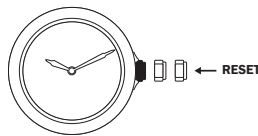
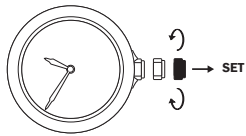

**SETTING THE DATE**  
CAUTION: NEVER CORRECT DATE  
BETWEEN 9 PM AND 0.30 AM.

**CORRECTION DE LA DATE**  
ATTENTION: LA CORRECTION  
DE LA DATE NE PEUT PAS  
SE FAIRE ENTRE 21H00 ET 0H30.

**EINSTELLEN DES DATUMS**  
ACHTUNG: DATUM NICHT  
ZWISCHEN 21 UHR UND 0 UHR  
30 EINSTELLEN.

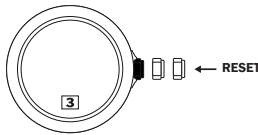
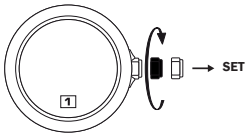

**ALARM AND POWER RESERVE**

MOVEMENT WITH ALARM REPETITION: IF THE ALARM IS NOT SWITCHED OFF  
DURING THE FIRST RINGING, A SECOND ALARM WILL OCCURS AFTER 2 MINUTES.

**ALARME ET RESERVE DE MARCHÉ**

MOVEMENT AVEC REPETITION ALARME: SI ELLE N'A PAS ÉTÉ DESACTIVÉE  
LORS DE LA PREMIÈRE SONNERIE, UNE 2ÈME INTERVIENT 2 MINUTES APRÈS.

**ALARM UND BATTERIE-ZUSTANDSANZEIGE**

WERK MIT ALARM REPETITION: WENN NACH DEM ERSTEM LAEUTEN NICHT  
AUSGESCHALTET WIRD, WIRD ER NACH 2 MINUTEN WIEDER AKTIVIERT.

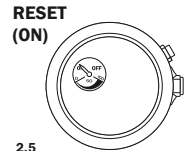
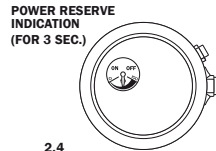
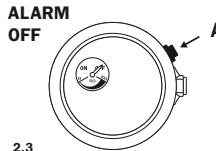
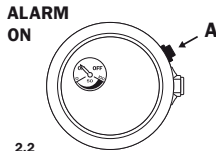
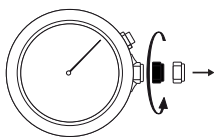

**AFTER BATTERY EXCHANGE  
OR MISHANDLING ONLY**

**SEULEMENT APRÈS CHANGEMENT DE  
LA PILE OU MAUVAISE MANIPULATION**

**NUR NACH BATTERIEWECHSEL  
ODER UNKORREKTER HANDHABUNG**

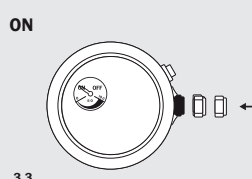
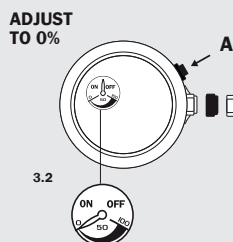
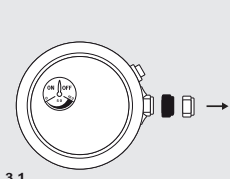

PRESENTATION – PRESENTAZIONE – PRESENTACION

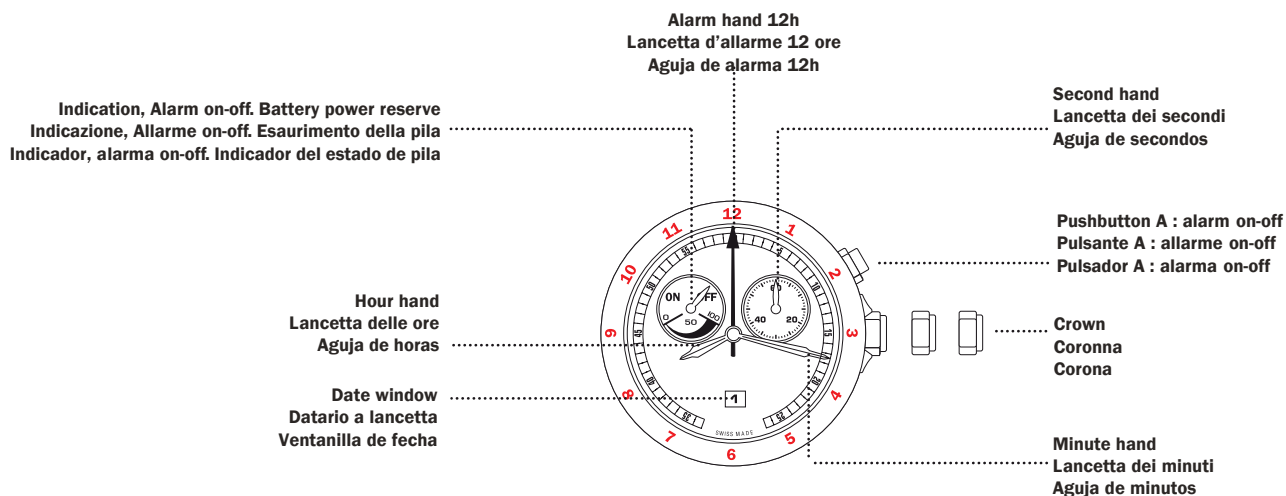

SETTINGS – CORREZIONE – AJUSTAR

SETTING THE TIME  
HOUR AND MINUTE

CORREZIONE DELL'ORA  
E MINUTI

AJUSTE HORA Y  
MINUTO

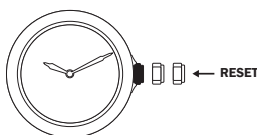
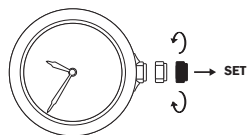

SETTING THE DATE  
CAUTION: NEVER CORRECT DATE  
BETWEEN 9 PM AND 0.30 AM.

CORREZIONE DELLA DATA  
ATTENZIONE: IL CAMBIO DI  
DATA NON È POSSIBILE DALLE  
ORE 21 ALLE ORE 0.30.

AJUSTE DE LA FECHA  
ATTENCIÓN: CAMBIAR LA  
FECHA NO SE PUEDE HACER  
DENTRO LAS 21H Y 0H30.

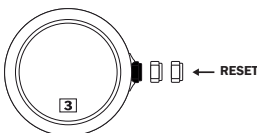
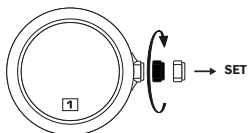

ALARM AND POWER RESERVE

MOVEMENT WITH ALARM REPETITION: IF THE ALARM IS NOT SWITCHED OFF  
DURING THE FIRST RINGING, A SECOND ALARM WILL OCCURS AFTER 2 MINUTES.

ALLARME E ESAURIMENTO DELLA PILA

MOVIMENTO CON RIPETIZIONE DELL'ALLARMA: SE QUELLA NON È STATA  
DISATTIVATO DURANTE LA PRIMA SUONERIA, UNA SECONDA  
INTERVIENE DOPO 2 MINUTI.

ALARMA Y ESTADO DE LA PILA

MOVIMIENTO CON REPETICION DE ALARMA: SI NO ES DESACTIVADO  
DURANTE EL PRIMERO TIMBRE, UN SEGUNDO INTERVIENE  
2 MINUTOS DESPUES.

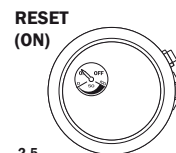
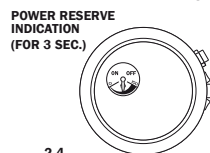
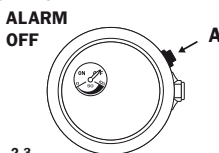
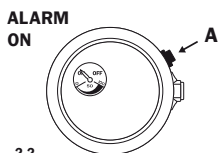
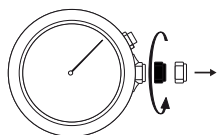

AFTER BATTERY EXCHANGE  
OR MISHANDLING ONLY

SOLAMENTE DOPO CAMBIO DELLA  
PILA O UTILIZZAZIONE ERRATA

SOLAMENTE DESPUES DE CAMBIAR  
LA PILA O MALA MANIPULACION

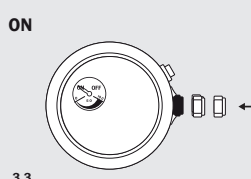
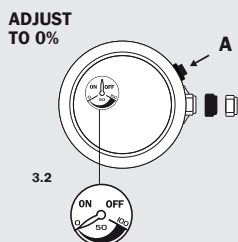
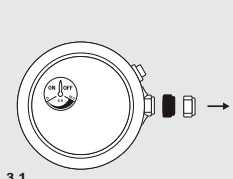

POWER RESERVE CALIBRATION  
INIZIALIZAZIONE ESAURIMENTO PILA  
INICIALIZACION INDICADOR DE PILA

INFO